

Installing the Wall Dock

Installation Steps

1. Connect all wiring.
2. Attach main chassis to j-box using the provided four 6-32 screws.
3. Feed the dock connector circuit board through the opening in the front cover.
4. Hang the front cover on the main chassis from the two top tabs.
5. Secure the front cover with the two small screws at the bottom.
6. Place the dock platform over the slide rail and push downward until the retention snaps are engaged.
7. Slide the side protectors into the slots on the main chassis.

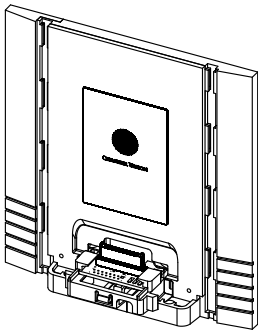
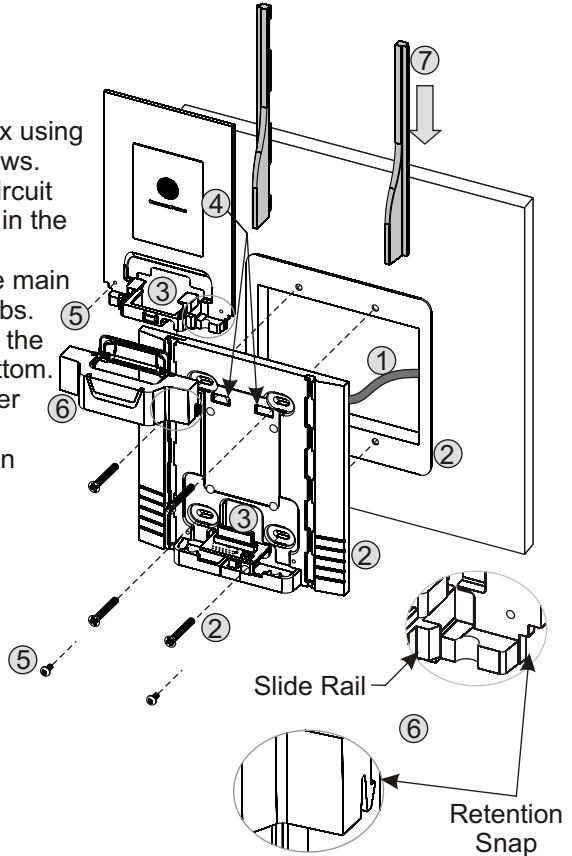

Steps 3 & 4 complete

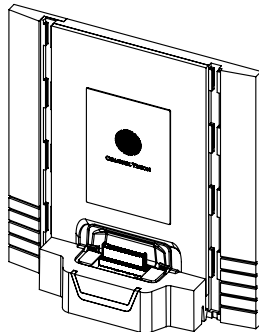

Steps 5 & 6 complete

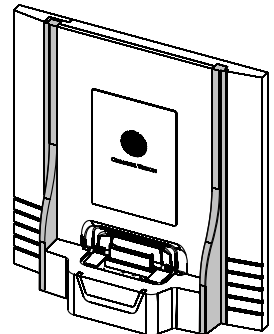

Completed Installation

Installing the Wall Dock (3-gang Installation)

In some installations it may be desirable to mount a single gang control keypad next to the A0314D. To accomplish this, the single gang trim plate can be installed next to the A0314D in a 3-gang junction box.

Follow the steps below:

Installation Steps

1. Connect all wiring. Use the correct installation tools: J-110 tool, or 1014 crimp tool.
2. Install keypad and single-gang trim plate in the far left position of the 3-gang junction box. (See details on page 3)
3. Leave off the right side flange and trim piece.
4. Install the iPod dock in the left side of the 3-gang j-box. It will overlap and snap into the single gang trim plate. (See page 5 for details)

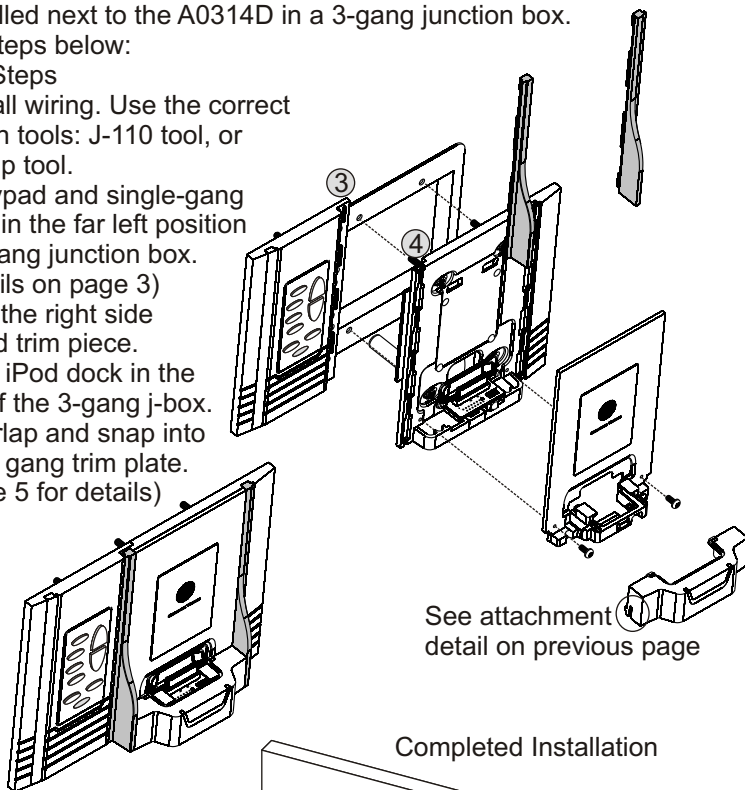

See attachment detail on previous page

Completed Installation

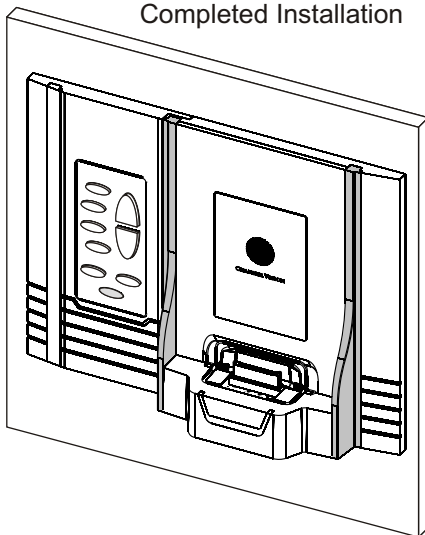

Docking the iPod

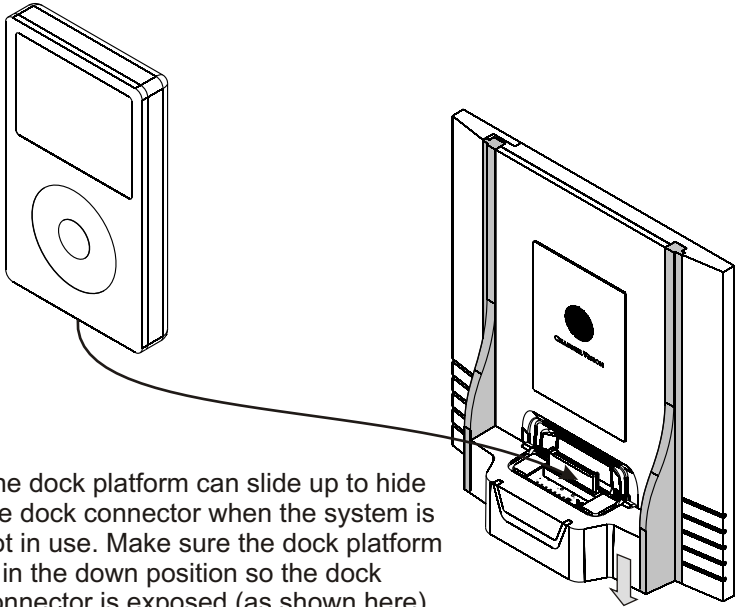

The dock platform can slide up to hide the dock connector when the system is not in use. Make sure the dock platform is in the down position so the dock connector is exposed (as shown here).

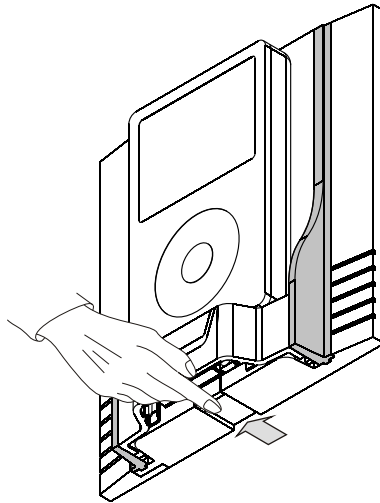

The sliding dock lever beneath the dock adjusts the position of the dock connector to create a perfect fit for all compatible iPods (see page 3 for a list of compatible iPods).

Using the A0505 Remote Control

The buttons above the iBus label on the A0505 remote control will mimic the functions on the iPod wheel.

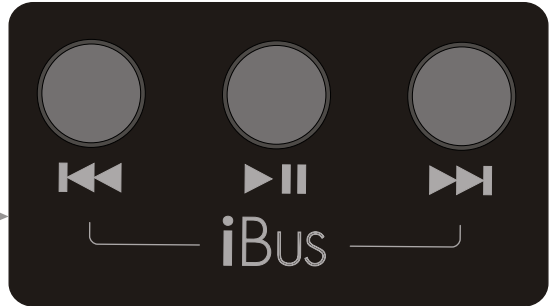
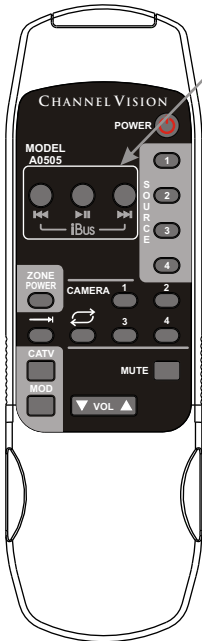

The volume, mute, power, and source buttons on the A0505 are designed to control Channel Vision's whole-house audio systems such as the A4603 and P-1044.

Please note that this remote will only function when your iPod is docked in the A0314D wall dock. It can be pointed directly at the wall dock or at an IR receiver that is part of an external whole-house IR system. An IR-4180 cable can be used to connect the emitter output of the whole-house IR system into the IR IN of the A0314D output wall plate. See page 5 of this manual for an example.

We realize that custom integrators may wish to design advanced control systems. To provide assistance we have published the hex codes for the IR commands (see below). (IR codes can be downloaded at: www.channelvision.com)

Hex codes for IR commands:

iBus Play/Pause:

0000 006D 0000 000B 001F 001F 001F 001F 003F 003F 001F 001F 001F 001F 001F 001F 003F 001F 001F 001F 003F 001F 0CA2

iBus Skip <<:

0000 006D 0000 000B 001F 001F 003F 001F 001F 003F 001F 001F 001F 001F 001F 003F 001F 001F 003F 001F 003F 003F 001F 0CA2

iBus Skip >>:

0000 006D 0000 000A 001F 001F 001F 001F 003F 003F 001F 001F 001F 001F 001F 003F 003F 001F 001F 003F 003F 00CC3

Connection Tips and Troubleshooting

- 1) Be sure you have connected the CAT5 cable correctly. Follow the TIA-568A standard at both ends. Incorrect wiring can cause distorted sound or prevent the system from working at all!
- 2) Be sure you have connected the speakers in phase. Follow the label on the product. Out of phase speakers can rob the system of its bass. Especially when driving dual-voice-coil speakers.
- 3) Trouble with IR control?
 - a. Make sure you are using the correct remote control. The A0314D will only respond to IR signals from the Apple Remote produced by Apple Computer or the A0505 produced by Channel Vision. Other 3rd party remote controls are not supported.
 - b. Disconnect anything that is connected to the “IR IN” on the output wall plate. Point the A0505 remote at the Wall Dock and see if you can control the iPod. If this works, you need to troubleshoot your IR repeating system.
 - c. Troubleshooting an external IR system: Some IR receivers have a feedback LED that flashes whenever IR signals are received. If the IR receiver you are using has this feature, check to make sure the LED flashes whenever you press buttons on your remote control.
 - i. If you don't see the feedback LED, try replacing the batteries in your remote control.
- 4) The A0314D is designed to charge the iPod (*see compatibility notes on page 3*). When the iPod is not playing music, the screen should indicate that the iPod is being charged. If this does not occur, make sure the power supply is connected to the output wall plate of the A0314D.
- 5) Observe wiring distance specifications. The maximum recommended wire length between the wall dock and output wall plate is 350 feet. Although the A0314D has been proven to work at distances of 500 feet, such extreme distances are not recommended because erratic performance may result due to the power loss caused by the CAT5 wire.
- 6) If you are experiencing problems with your iPod that occur even when it is not docked in the A0314D, then please contact Apple customer service for support.
- 7) If you need additional help troubleshooting the A0314D please contact Channel Vision technical support or check our website for more details: www.channelvision.com.

Stripping and Connecting CAT5 Wire

CAT5 cable should be stripped with a proper stripping tool, such as Channel Vision's J-110 tool.

1. Place the CAT5 between the blade and the first notch of the J-110 tool.

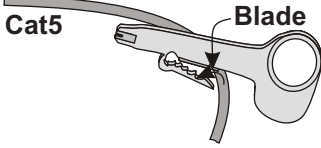

2. Rotate the tool only once. Multiple turns will cause you to cut into the inner wires.

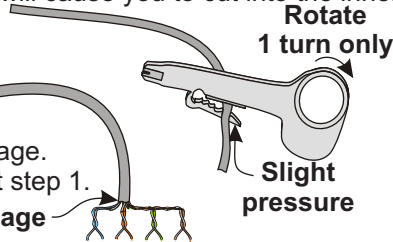

3. Inspect the inner wires for damage. If any wires are cut start over at step 1.

Check for damage

TIA-568A RJ-45 Modular Plug

Side view:

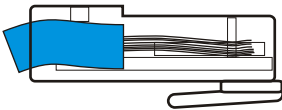

Top view:

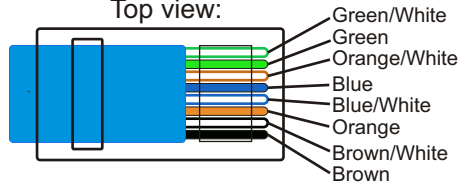

Specifications: (typical @25° C)

Audio Output

Output Level:	0.9 Vrms (may vary with iPod model)
THD + Noise:	<0.2%, 20Hz-20kHz
Signal/Noise:	>-96dB
Frequency Response:	20Hz-20kHz +/- 0.3dB
Output Impedance:	600 Ohms

Power Requirements:

Power Supply:

15VDC @ 0.500A (500mA)

Wire type:

15VDC @ 850mA

Recommended Max. Cable Length:

4-pair, UTP Category 5, 5e or 6

Video Output:

350ft.

Video Type:

1 Vp-p (may vary with iPod model)

Dimensions

Composite

Wall Dock (2-gang):

4.88"W x 5.14"H x 1.24"D(front)

Rear Depth: 1.56"

Wall Dock & Keypad (3-gang):

6.73"W x 5.14"H x 1.24"D(front)

Rear Depth: 1.56"

Output Plate (1-gang):

3.15"W x 5.14"H x 1.24"D(front)

Rear Depth: 1.95"

Color:

White

Operating Temperature:

-10°C to +50°C

Specifications subject to change without notice.



1 Year Limited Warranty

Channel Vision Technology will repair or replace any defect in material or workmanship which occurs during normal use of this product with new or rebuilt parts, free of charge in the USA, for one year from the date of original purchase. This is a no hassle warranty with no mail in warranty card needed. This warranty does not cover damages in shipment, failures caused by other products not supplied by Channel Vision Technology, or failures due to accident, misuse, abuse, or alteration of the equipment. This warranty is extended only to the original purchaser, and a purchase receipt, invoice, or other proof of original purchase date will be required before warranty repairs are provided.

Mail in service can be obtained during the warranty period by calling (800) 840-0288 toll free. A Return Authorization number must be obtained in advance and can be marked on the outside of the shipping carton.

This warranty gives you specific legal rights and you may have other rights (which vary from state to state). If a problem with this product develops during or after the warranty period, please contact Channel Vision Technology, your dealer or any factory-authorized service center.

Channel Vision products are not intended for use in medical, lifesaving, life sustaining or critical environment applications. Channel Vision customers using or selling Channel Vision products for use in such applications do so at their own risk and agree to fully indemnify Channel Vision for any damages resulting from such improper use or sale.

"Made for iPod" means that an electronic accessory has been designed to connect specifically to iPod and has been certified by the developer to meet Apple performance standards.

Apple is not responsible for the operation of this device or its compliance with safety and regulatory standards.

iPod is a trademark of Apple Inc., registered in the U.S. and other countries.

FC Tested To Comply
With FCC Standards

Model: A0314D iPod Wall Dock for Distributed Audio

This device complies with part 15 of the FCC rules. Operation is subject to the following two conditions: (1) This device may not cause harmful interference, and (2) This device must accept any interference received, including interference that may cause undesired operation.



234 Fischer Avenue, Costa Mesa, California 92626 USA
(714)424-6500 • (800)840-0288 • (714)424-6510 fax
email: techsupport@channelvision.com